

## PCB Conn. 3.96mm

- B-138 ▶ Pin Header 3.96mm 1 Row H=3.20mm SMT Type
- B-138 ▶ Pin Header 3.96mm 1 Row H=3.20mm Stack SMT Type
- B-139 ▶ Pin Header 3.96mm 1 Row H=3.18mm Right Angle Type
- B-139 ▶ Pin Header 3.96mm 1 Row H=3.20mm SMT R/A Type
- B-140 ▶ Pin Header 3.96mm 1 Row H=3.18mm Straight Type
- B-140 ▶ Pin Header 3.96mm 1 Row H=3.20mm Stack Straight Type
- B-141 ▶ Female Header 3.96mm 1 Row H=8.89mm SMT Type
- B-141 ▶ Female Header 3.96mm 1 Row H=8.89mm Straight Type

## PCB Conn. 4.2mm

- B-142 ▶ Pin Header 4.2mm 2 Row H=2.5mm SMT Type
- B-142 ▶ Pin Header 4.2mm 2 Row H=2.5mm Straight Type

## PCB Conn. 5.08mm

- B-143 ▶ Pin Header 5.08mm 1 Row H=2.5mm SMT Type
- B-143 ▶ Pin Header 5.08mm 1 Row H=2.5mm Stack SMT Type
- B-144 ▶ Pin Header 5.08mm 1 Row H=2.5mm Right Angle Type
- B-144 ▶ Pin Header 5.08mm 1 Row H=3.5mm Right Angle Type
- B-145 ▶ Pin Header 5.08mm 1 Row H=2.5mm Straight Type
- B-145 ▶ Pin Header 5.08mm 1 Row H=2.5mm Stack Straight Type
- B-146 ▶ Female Header 5.08mm 1 Row H=8.9mm SMT Type
- B-146 ▶ Female Header 5.08mm 1 Row H=8.9mm Straight Type
- B-147 ▶ Mini Jumper 5.08mm



RoHS

# ICCONNECTORS

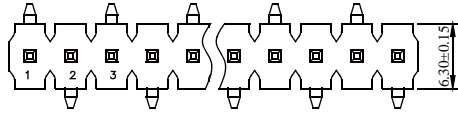
## Pin Header 3.96mm 1 Row H=3.20mm SMT Type

### Specifications

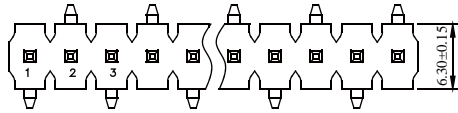
Current Rate:7 AMP  
 Insulation Resistance:1000MΩ Min.  
 Contact Resistance:20mΩ Max.  
 Dielectric Voltage:1000V AC for one minute  
 Operation Temperature:-40°C to +105°C

### Material

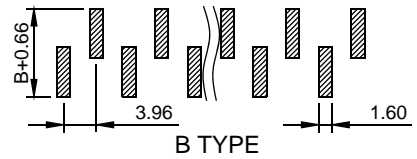
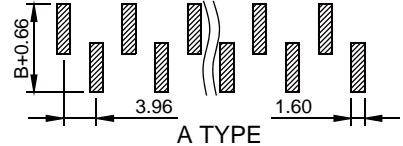
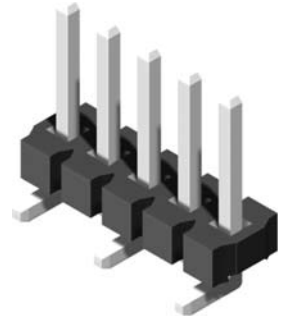
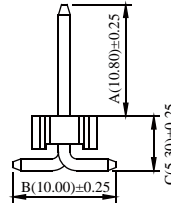
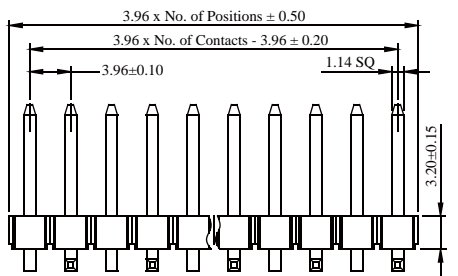
Insulator:Polyester,UL 94V-0  
 ©Standard:LCP  
 Termianl:Copper Alloy  
 Plating:Tin Plated



A TYPE



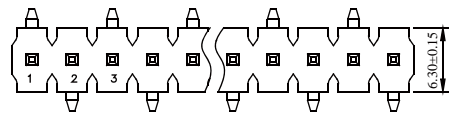
B TYPE



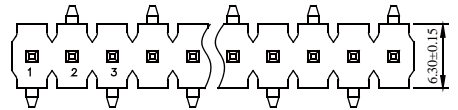
Recommended P.C.B Layout(Top Side)  
 (PCB BOARD TOLERANCE±0.05)

Part No.:PH396M32-1XX-U

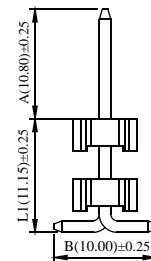
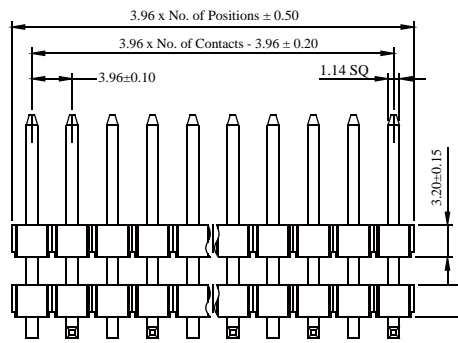
## Pin Header 3.96mm 1 Row H=3.20mm Stack SMT Type



A TYPE



B TYPE



Recommended P.C.B Layout(Top Side)  
 (PCB BOARD TOLERANCE±0.05)



Part No.:PH396DM32-1XX-U

## ORDER INFORMATION

P H 3 9 6 X 3 2 - 1 X X X

M:SMT Single Insulator  
 DM:SMT Dual Insulator

No. of Contacts Per Row  
 (01~20)

G:Gold Flash	S:Selective
GA:Gold 5u"	SA:Selective 5u"
GB:Gold 10u"	SB:Selective 10u"
GC:Gold 20u"	SC:Selective 20u"
GD:Gold 30u"	SD:Selective 30u"
©:Tin Plated	TE:Tin 200u"

©B:Black Insulator

Fill in Dimensions For  
 Special Design  
 or See Table

U:RoHS + LCP



RoHS

# ICCONNECTORS

## Pin Header 3.96mm 1 Row H=3.18mm Right Angle Type

### Specifications

Current Rate:7 AMP  
 Insulation Resistance:1000MΩ Min.  
 Contact Resistance:20mΩ Max.  
 Dielectric Voltage:1000V AC for one minute  
 Operation Temperature:-40°C to +105°C

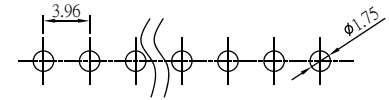
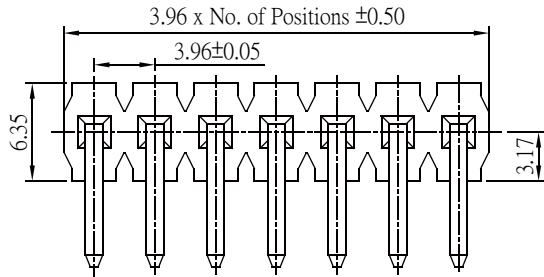
### Material

Insulator:Polyester,UL 94V-0  
 ©Standard:LCP  
 Terminal:Copper Alloy  
 Plating:Tin Plated

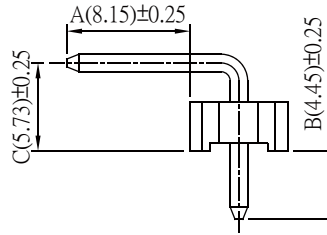
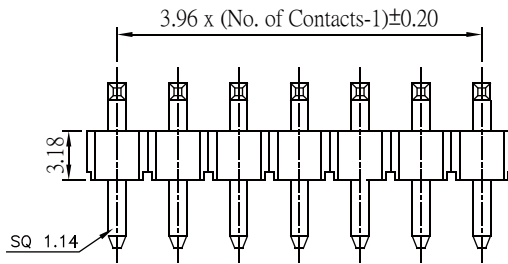


Table:

LEAD STYLE	Dimensions		
	A	B	C
01	8.15	4.45	5.73
02	13.60	4.00	8.13
03	10.75	4.50	9.48



Recommended PCB Layout (PCB TOLERANCE ±0.05)



Part No.:PH396R32-1XX-U

## Pin Header 3.96mm 1 Row H=3.18mm Straight Type

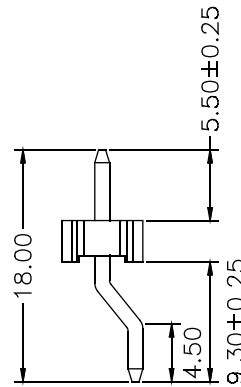
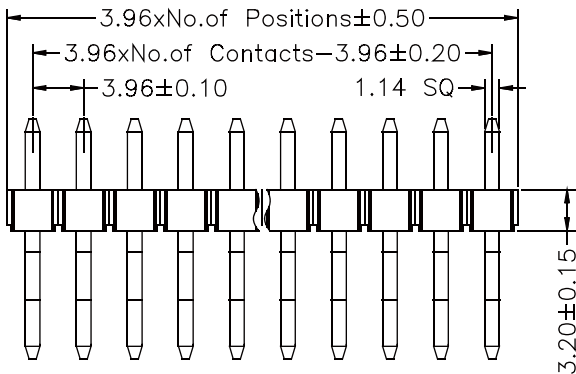
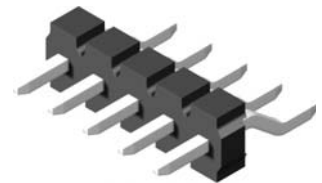
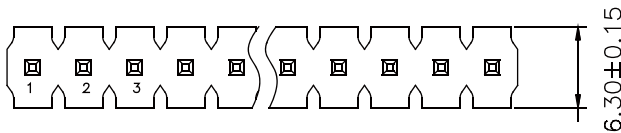
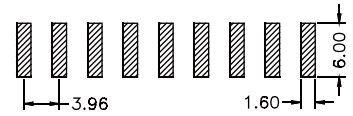


Table:

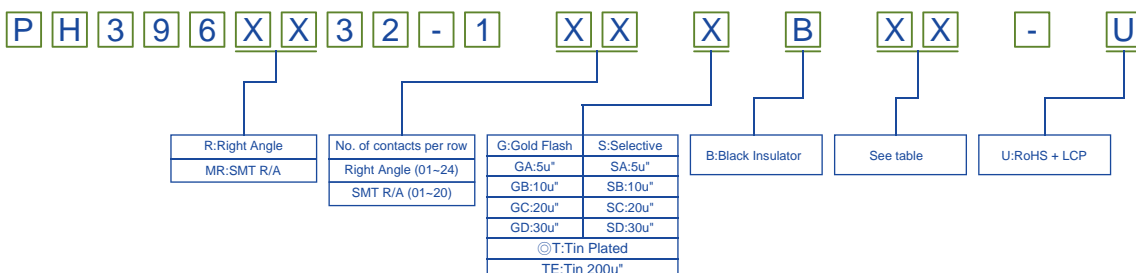
LEAD STYLE	DIMENSION		
	A	B	C
01	8.15	4.45	5.73
02	13.60	4.00	8.13
03	10.75	4.50	9.46



Recommended PCB Layout (PCB TOLERANCE ±0.05)

Part No.:PH396MR32-1XX-U

## ORDER INFORMATION



©:Standard Recommended

click on: [sales@icconnectors.com](mailto:sales@icconnectors.com) to send email



RoHS

# ICCONNECTORS

## Pin Header 3.96mm 1 Row H=3.18mm Straight Type

### Specifications

Current Rate:7 AMP  
 Insulation Resistance:1000MΩ Min.  
 Contact Resistance:20mΩ Max.  
 Dielectric Voltage:1000V AC for one minute  
 Operation Temperature:-40°C to +105°C

### Material

Insulator:Polyester,UL 94V-0  
 ©Standard:LCP  
 Termianl:Copper Alloy  
 Plating:Tin Plated

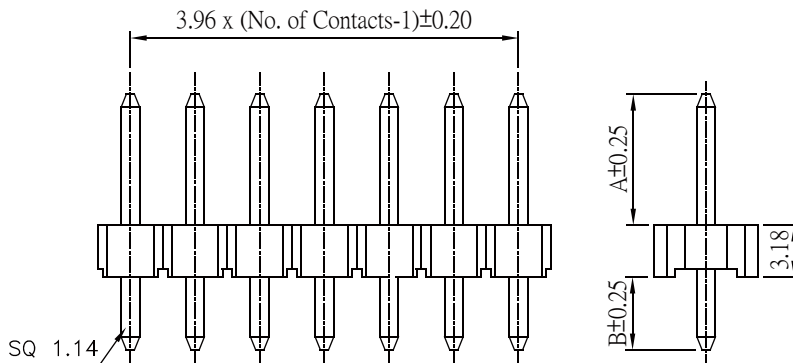
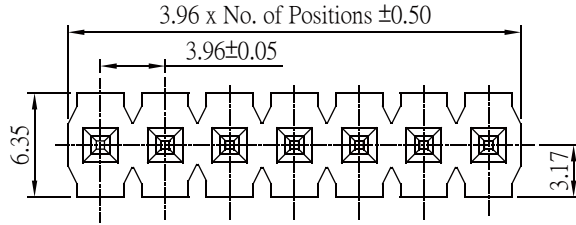
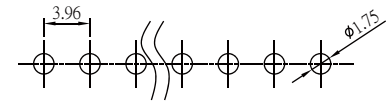


Table:

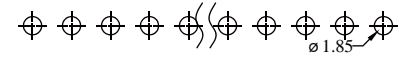
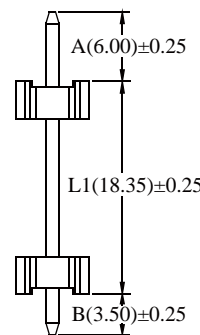
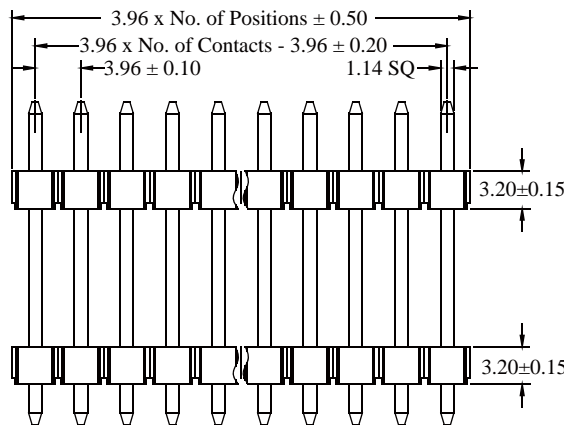
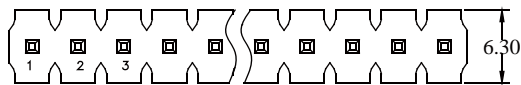
LEAD STYLE	Dimensions	
	Dim.A	Dim.B
02	11.45	4.45
03	12.70	4.00
04	20.55	4.00
05	3.80	12.10
06	11.43	3.18



Recommended PCB Layout (PCB TOLERANCE ±0.05)

Part No.:PH396S32-1XX-U

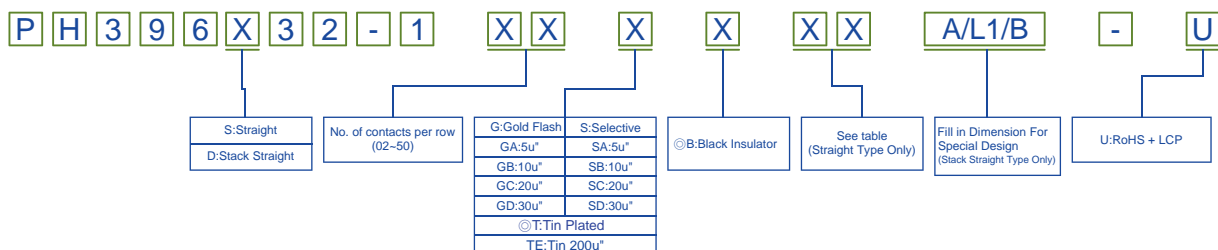
## Pin Header 3.96mm 1 Row H=3.20mm Stack Straight Type



Recommended P.C.B Layout(Top Side) (PCB BOARD TOLERANCE±0.05)

Part No.:PH396D32-1XX-U

## ORDER INFORMATION



©Standard Recommended



RoHS

# ICCONNECTORS

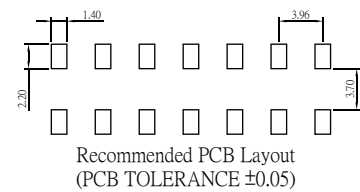
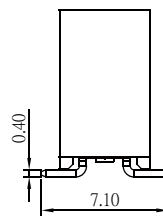
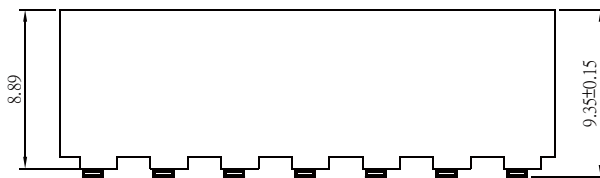
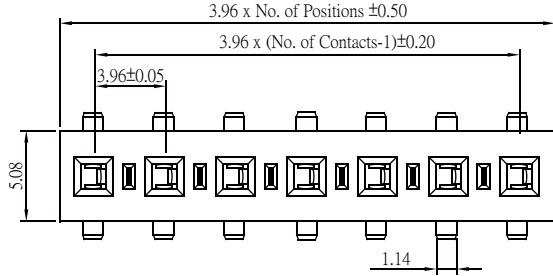
## Female Header 3.96mm 1 Row H=8.89mm SMT Type

### Specifications

Current Rate:7 AMP  
 Insulation Resistance:1000MΩ Min.  
 Contact Resistance:20mΩ Max.  
 Dielectric Voltage:1000V AC for one minute  
 Operation Temperature:-40°C to +105°C

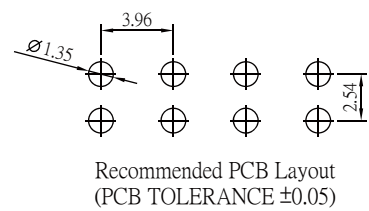
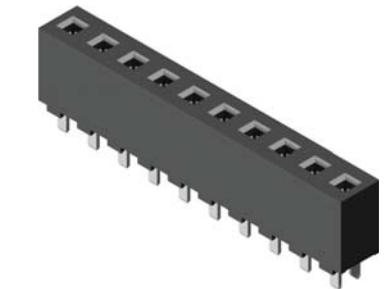
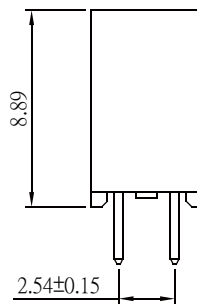
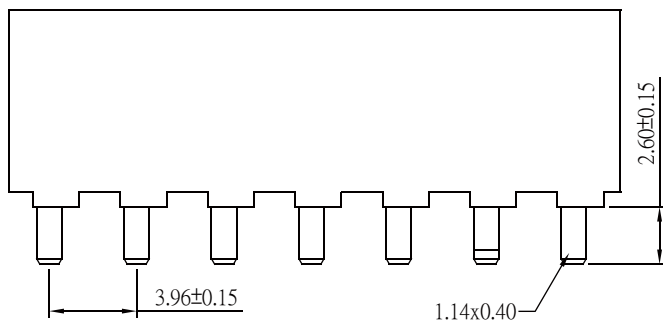
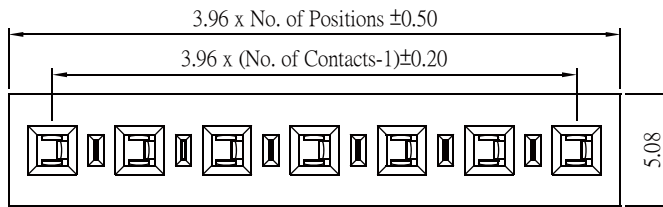
### Material

Insulator:Polyester,UL 94V-0  
 ©Standard:LCP  
 Terminal:Copper Alloy  
 Plating:Tin Plated



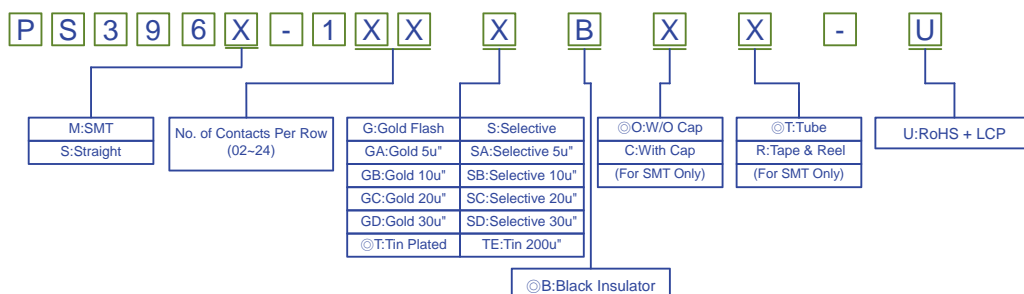
Part No.:PS396M89-1XX-U

## Female Header 3.96mm 1 Row H=8.89mm Straight Type



Part No.:PS396S89-1XX-U

## ORDER INFORMATION



©Standard Recommended

click on: [sales@icconnectors.com](mailto:sales@icconnectors.com) to send email

B-141



RoHS

# ICCONNECTORS

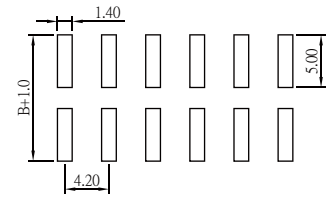
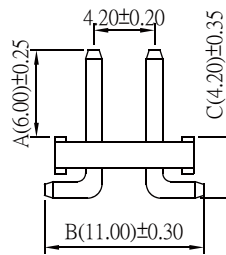
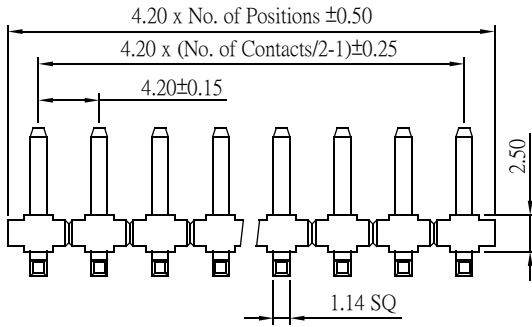
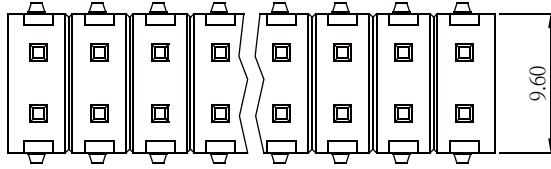
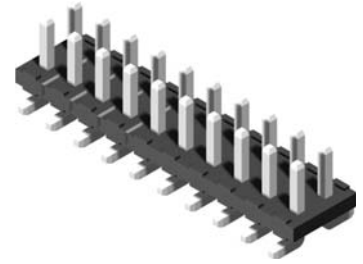
## Pin Header 4.2mm 2 Row H=2.5mm SMT Type

### Specifications

Current Rate:7 AMP  
 Insulation Resistance:1000MΩ Min.  
 Contact Resistance:20mΩ Max.  
 Dielectric Voltage:1000V AC for one minute  
 Operation Temperature:-40°C to +105°C

### Material

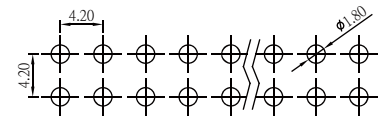
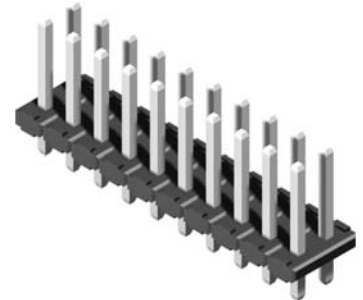
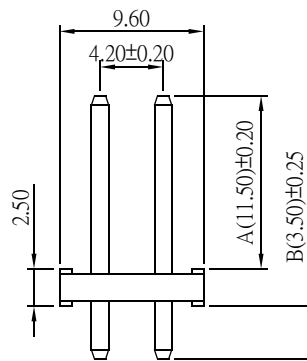
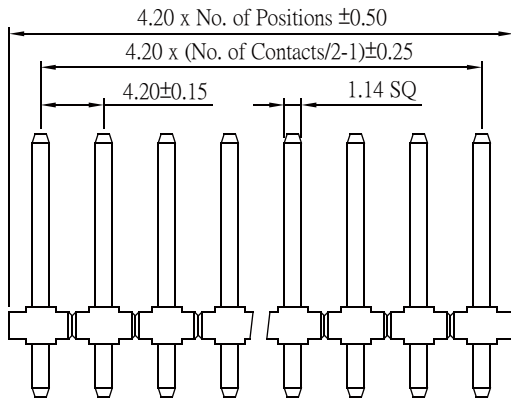
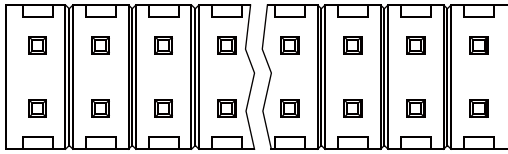
Insulator:Polyester,UL 94V-0  
 ◎Standard SMT:Nylon 6T,  
 Straight:Nylon 66  
 Terminal:Copper Alloy  
 Plating:Tin Plated



Recommended PCB Layout  
(PCB TOLERANCE ±0.05)

Part No.:PH42M25-2XX-U

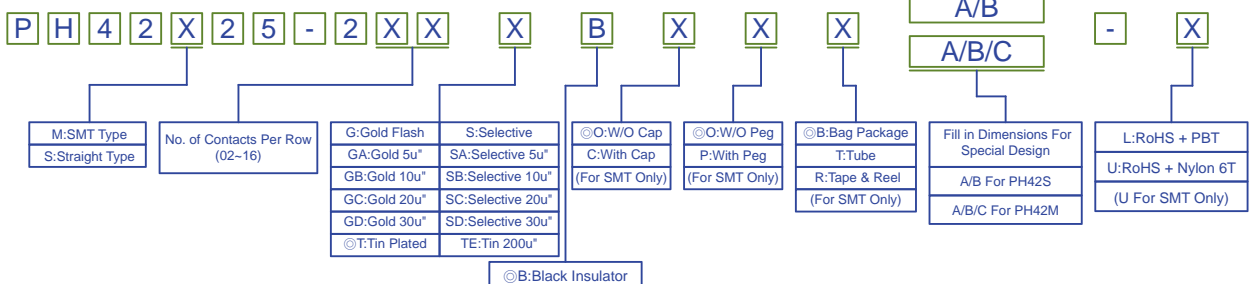
## Pin Header 4.2mm 2 Row H=2.5mm Straight Type



Recommended PCB Layout  
(PCB TOLERANCE ±0.05)

Part No.:PH42S25-2XX-L

## ORDER INFORMATION



◎:Standard Recommended

click on: [sales@icconnectors.com](mailto:sales@icconnectors.com) to send email



RoHS

# ICCONNECTORS

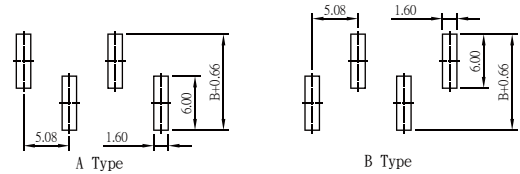
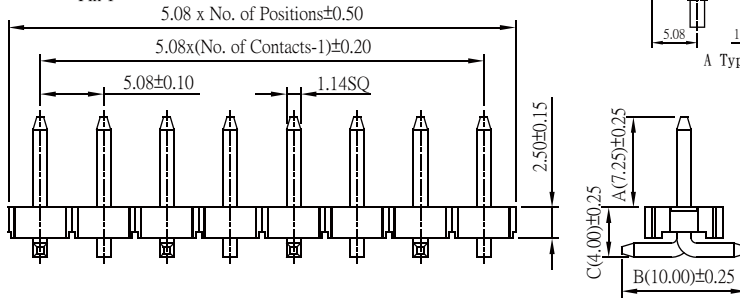
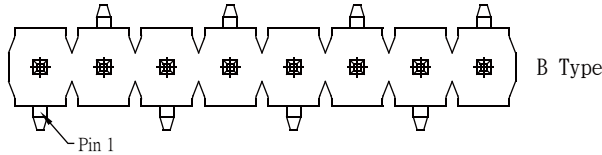
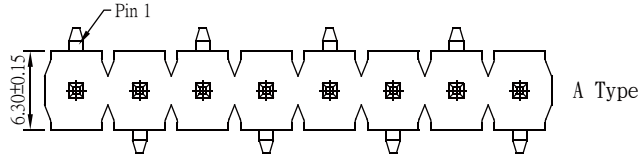
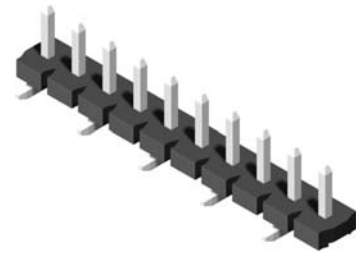
## Pin Header 5.08mm 1 Row H=2.5mm SMT Type

### Specifications

Current Rate: 7 AMP  
 Insulation Resistance: 1000MΩ Min.  
 Contact Resistance: 20mΩ Max.  
 Dielectric Voltage: 1000V AC for one minute  
 Operation Temperature: -40°C to +105°C

### Material

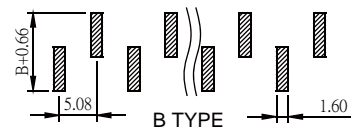
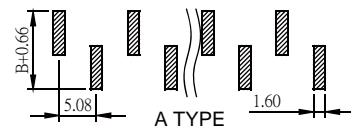
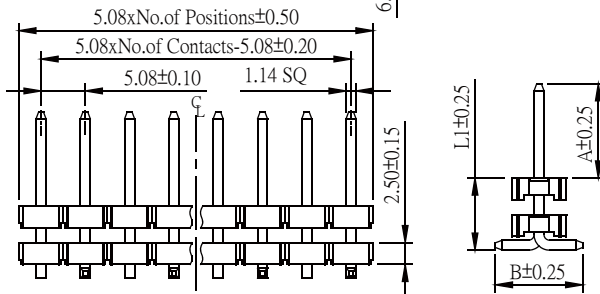
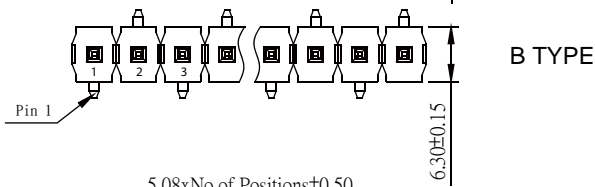
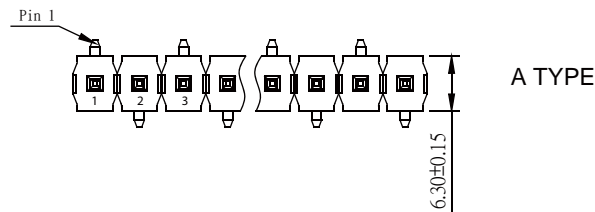
Insulator: Polyester, UL 94V-0  
 ©Standard: LCP  
 Terminal: Copper Alloy  
 Plating: Tin Plated



Recommended PCB Layout (PCB TOLERANCE ±0.05)

Part No.: PH8M25-1XX-U

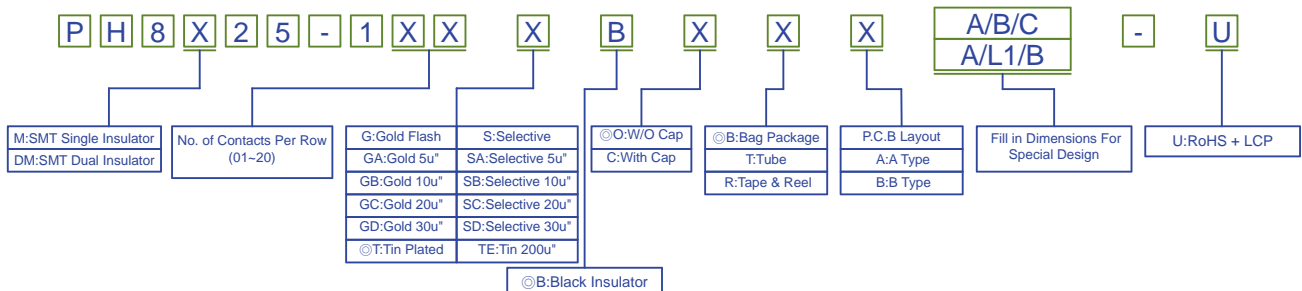
## Pin Header 5.08mm 1 Row H=2.5mm Right Angle Type



Recommended P.C.B Layout (Top Side) (PCB BOARD TOLERANCE ±0.05)

Part No.: PH8DM25-1XX-U

## ORDER INFORMATION



©Standard Recommended

click on: [sales@icconnectors.com](mailto:sales@icconnectors.com) to send email



RoHS

# ICCONNECTORS

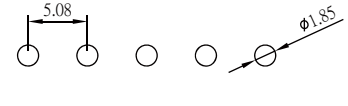
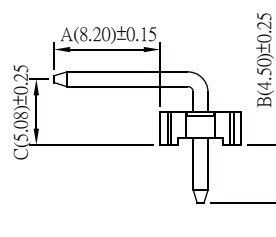
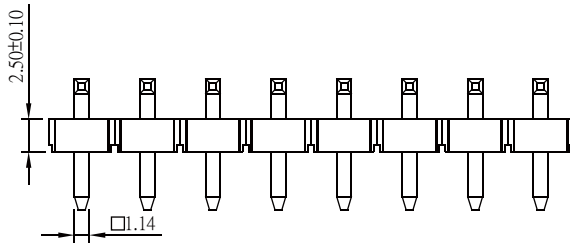
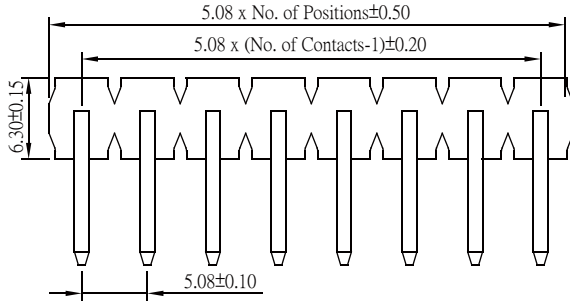
## Pin Header 5.08mm 1 Row H=2.5mm Right Angle Type

### Specifications

Current Rate:7 AMP  
 Insulation Resistance:1000MΩ Min.  
 Contact Resistance:20mΩ Max.  
 Dielectric Voltage:1000V AC for one minute  
 Operation Temperature:-40°C to +105°C

### Material

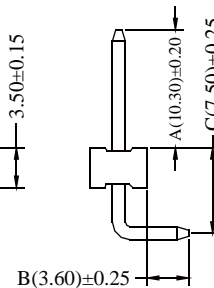
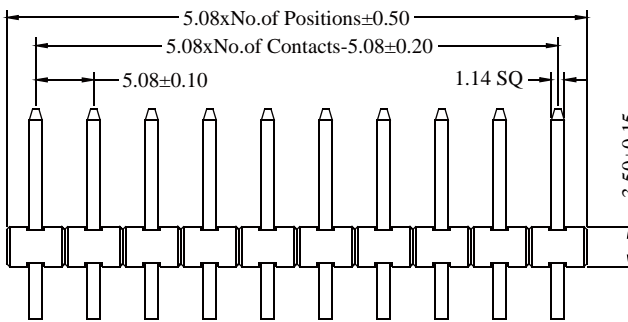
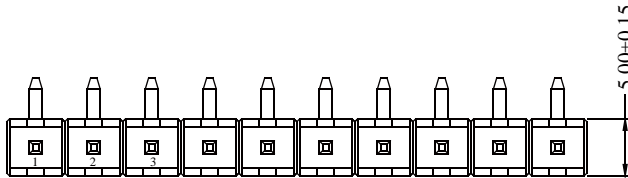
Insulator:Polyester,UL 94V-0  
 ©Standard:LCP  
 Terminal:Copper Alloy  
 Plating:Tin Plated



Recommended PCB Layout  
 (PCB TOLERANCE ±0.05)

Part No.:PH8RU25-1XX-U

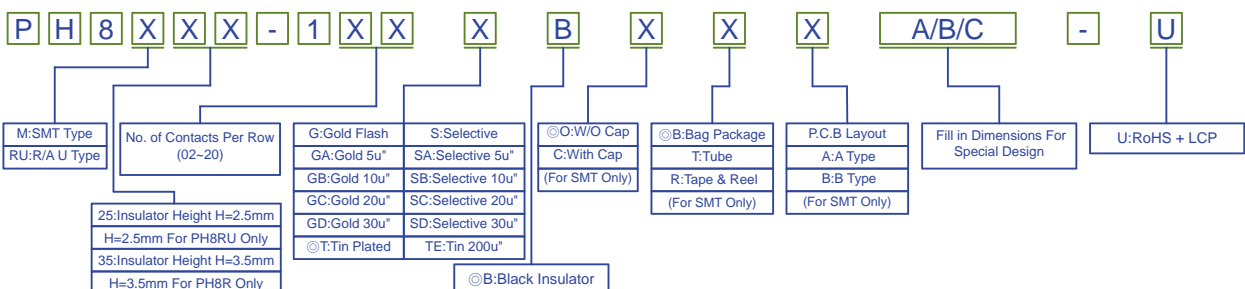
## Pin Header 5.08mm 1 Row H=3.5mm Right Angle Type



Recommended P.C.B Layout (Top Side)  
 (PCB BOARD TOLERANCE ±0.05)

Part No.:PH8R35-1XX-U

## ORDER INFORMATION



©:Standard Recommended

click on: [sales@icconnectors.com](mailto:sales@icconnectors.com) to send email





RoHS

# ICCONNECTORS

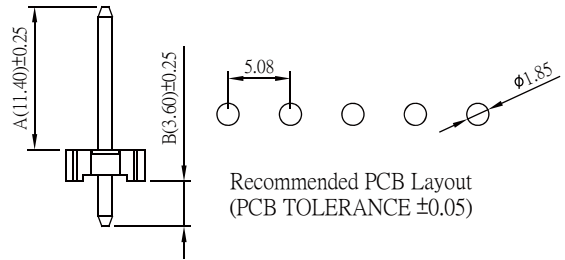
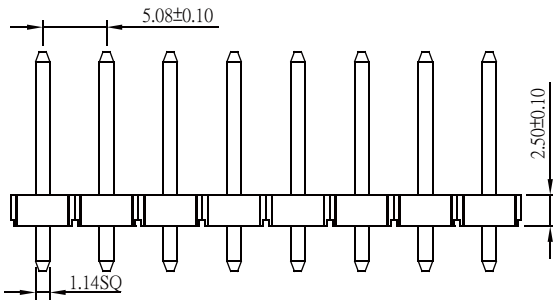
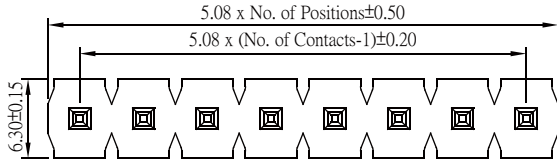
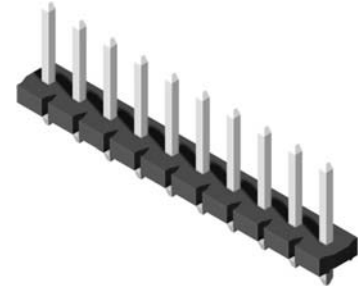
## Pin Header 5.08mm 1 Row H=2.5mm Straight Type

### Specifications

Current Rate:7 AMP  
 Insulation Resistance:1000MΩ Min.  
 Contact Resistance:20mΩ Max.  
 Dielectric Voltage:1000V AC for one minute  
 Operation Temperature:-40°C to +105°C

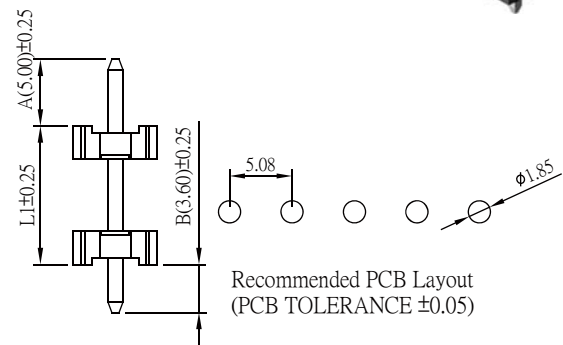
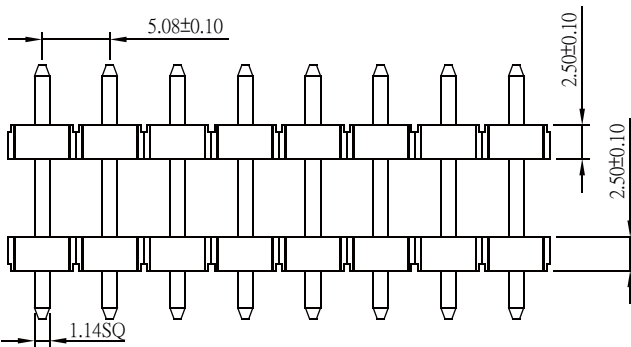
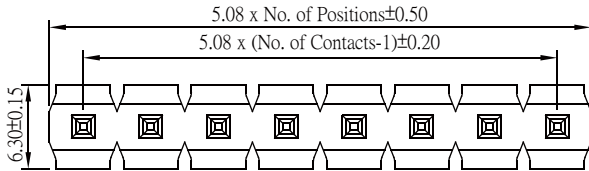
### Material

Insulator:Polyester,UL 94V-0  
 ©Standard:LCP  
 Terminal:Copper Alloy  
 Plating:Tin Plated



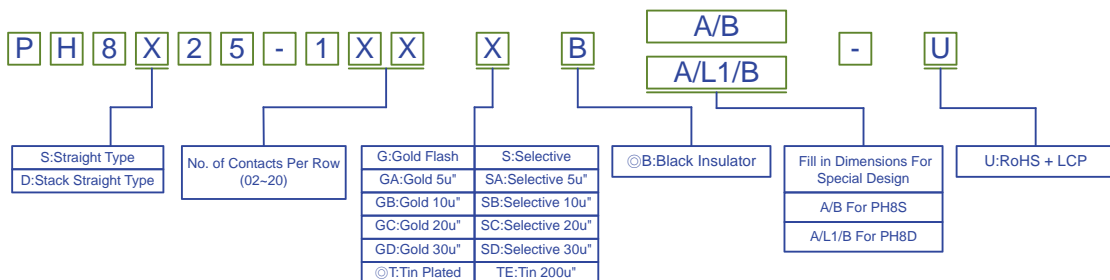
Part No.:PH8S25-1XX-U

## Pin Header 5.08mm 1 Row H=2.5mm Stack Straight Type



Part No.:PH8D25-1XX-U

## ORDER INFORMATION



©: Standard Recommended

click on: [sales@icconnectors.com](mailto:sales@icconnectors.com) to send email

B-145



RoHS

# ICCONNECTORS

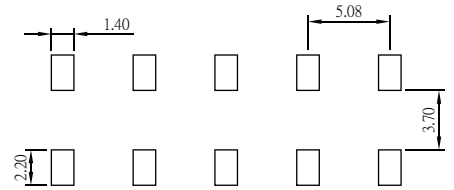
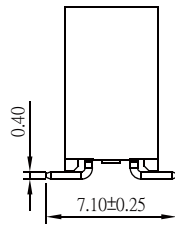
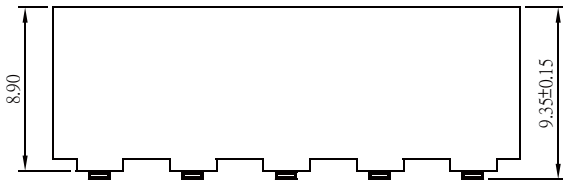
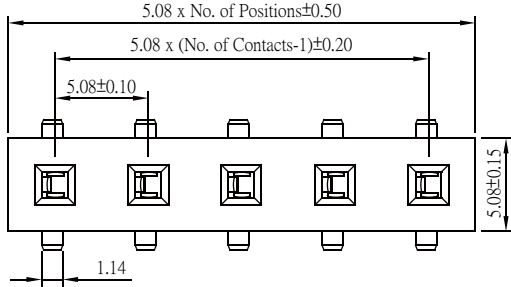
## Female Header 5.08mm 1 Row H=8.9mm SMT Type

### Specifications

Current Rate:7 AMP  
 Insulation Resistance:1000MΩ Min.  
 Contact Resistance:20mΩ Max.  
 Dielectric Voltage:1000V AC for one minute  
 Operation Temperature:-40°C to +105°C

### Material

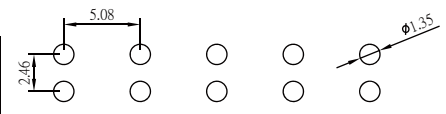
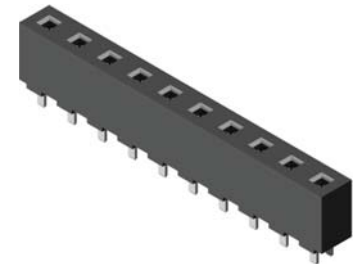
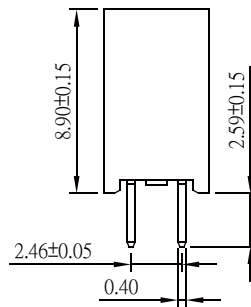
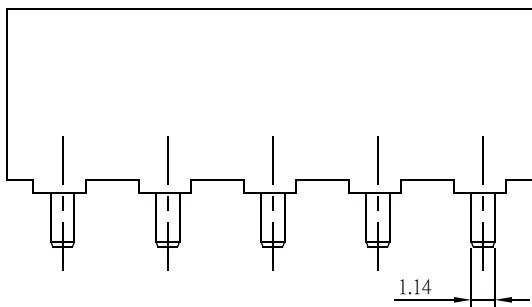
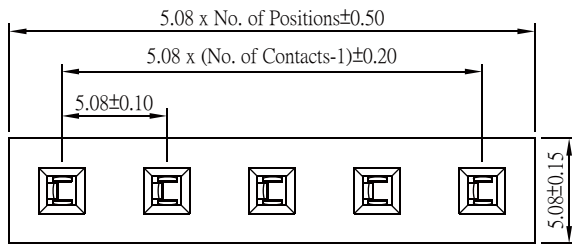
Insulator:Polyester,UL 94V-0  
 ©Standard:LCP  
 Terminal:Copper Alloy  
 Plating:Tin Plated



Recommended PCB Layout  
 (PCB TOLERANCE ±0.05)

Part No.:PS8M89-1XX-U

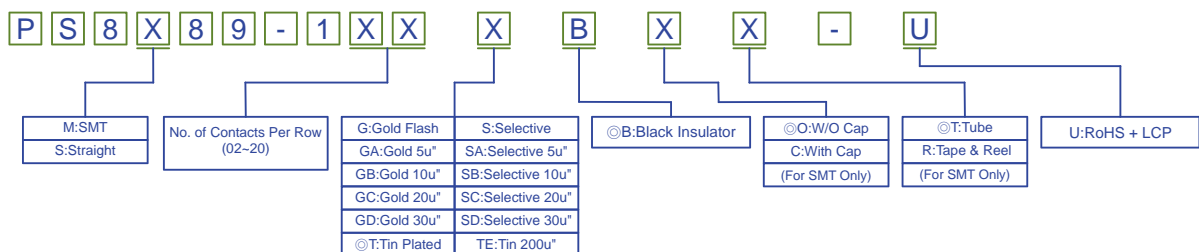
## Female Header 5.08mm 1 Row H=8.9mm Straight Type



Recommended PCB Layout  
 (PCB TOLERANCE ±0.05)

Part No.:PS8S89-1XX-U

## ORDER INFORMATION



©Standard Recommended

click on: [sales@icconnectors.com](mailto:sales@icconnectors.com) to send email

B-146



RoHS

# ICCONNECTORS

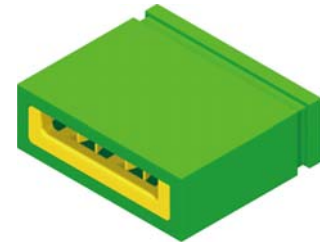
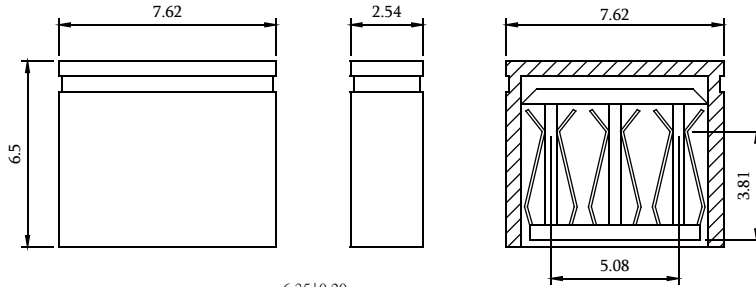
## Mini Jumper 5.08mm

### Specifications

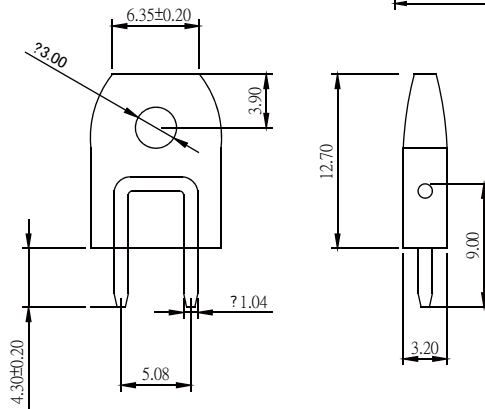
Current Rate:7 AMP  
 Insulation Resistance:1000MΩ Min.  
 Contact Resistance:20mΩ Max.  
 Dielectric Voltage:1000V AC for one minute  
 Operation Temperature:-40°C to +105°C

### Material

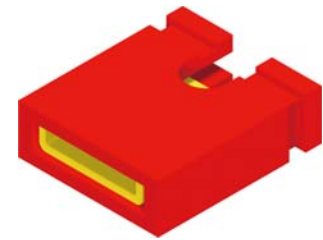
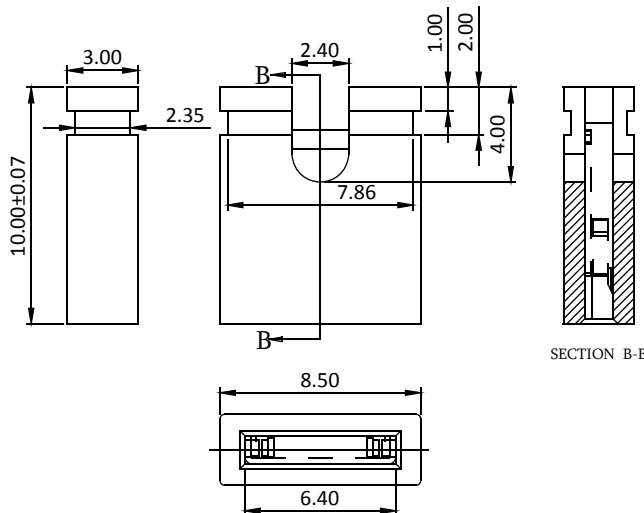
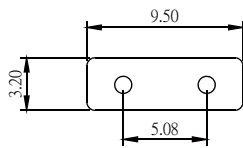
Insulator:Polyester,UL 94V-0  
 ©Standard:LCP  
 Terminal:Copper Alloy  
 Plating:Gold Plated



A Type

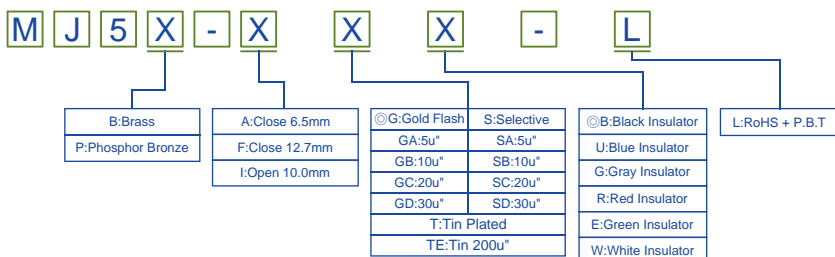


F Type



I Type

## ORDER INFORMATION



©Standard Recommended

click on: [sales@icconnectors.com](mailto:sales@icconnectors.com) to send email